



**Excellence** - *Our Guiding Principle*

**Illinois Law Enforcement  
Training and Standards Board  
Executive Institute**

**Leadership · Partner · Serve · Guide · Empower**



---

# **2022 Women in Criminal Justice Conference**

April 12-13, 2022  
Bloomington-Normal Marriott  
Hotel and Conference Center

## **Exhibitor Prospectus**

Dear Company Representative:

The Illinois Law Enforcement Training and Standards Board Executive Institute will host its 9th Annual *Women in Criminal Justice Conference* April 12-13, 2022 at the Bloomington-Normal Marriott Hotel and Conference Center.

Our last in person conference drew more than 275 participants from the criminal justice field throughout the state of Illinois. Attendees come from all areas of public safety including municipal, county, state, and federal agencies, campus law enforcement, public safety training organizations, academia, and the corrections field.

I wish to invite you to join us in what will surely be a worthwhile conference. The interactive participation of attendees in the exhibit area at our event will be a significant factor in the educational goals for the conference and we have developed several ways to ensure the visibility of exhibitors to attendees. This includes breaks, a networking reception, and door prize drawings also in the exhibitor area!

There are several opportunities for exhibitors and sponsorships available. For a complete listing of sponsorship types and benefits please see the enclosed sponsorship chart. The deadline for reserving your space as an exhibitor or sponsor is February 15, 2022.

We look forward to another successful conference and greatly appreciate our sponsors and exhibitors in helping to make it happen. To reserve your space or request further information, contact Cindi Bricker at [cj-bricker@wiu.edu](mailto:cj-bricker@wiu.edu) or 309-298-2646. The mailing address for the ILETSB Executive Institute is 1 University Circle, Macomb, Illinois 61455.

Thank you for your consideration. We look forward to your representation at the conference!

Sincerely,

A handwritten signature in black ink, appearing to read "Heather F. Hotz". The signature is fluid and cursive, with the first name being the most prominent.

Heather F. Hotz  
Director

# **SPONSORSHIP FACT SHEET**

## **Background**

Founded in 1992, the Illinois Law Enforcement Training and Standards Board (ILETSB) Executive Institute is dedicated to developing leaders in the law enforcement community. We address the numerous challenges law enforcement administrators face and those that will emerge as important issues during the course of the next decade and beyond. Our organization develops the values and competencies that are the institution of public service.

Clients of the ILET SB Executive Institute are high-performing supervisors, managers and executives who are committed to promoting professionalism in policing.

Following the ILET SB mission, the Executive Institute conducts research and evaluation to develop and improve law enforcement standards and training based on objective knowledge and the performance needs required.

## **Value of Partnership**

When you participate in the Women in Criminal Justice conference as an exhibitor, your organization's message will directly reach more than 250 individuals at the conference in the criminal justice field including chiefs of police, commanders, administrators, first-line supervisors, campus law enforcement, correctional staff, and other members of the criminal justice field. In turn, these individuals take back your marketing materials and products to others in the field, allowing for a large network of individuals who can potentially utilize your services. Becoming an exhibitor makes smart use of your marketing tools to touch many individuals in one location.

## **Anticipated Attendance**

- Approximately 250 attendees from every level of law enforcement
- Chief Executives, Managers, and Supervisors
- Municipal, county, state, and federal agency staff
- Corrections
- Probation
- Campus law enforcement
- Other exhibitors for networking

## **Conference Structure**

Two days of activities including general sessions, break-out sessions for specific interest areas, a networking reception, and other activities for everyone who attends.

## **Exhibitor Display Area**

- 8x8 Booth Area
- 1 Table, 2 Chairs
- Conference "goodie" bag
- Electricity

## **SPONSORSHIP PACKAGES**

### **Corporate Attended Booth**

- Cost - \$500
- Company logo placed in the Program Booklet
- Link from ILETSBEI Website to Exhibitor's home page
- Two tickets for each meal during the conference
- Invitation to networking reception
- Discounted conference registration price for exhibitor staff who want to attend the conference as participants

### **Not-for-Profit Attended Booth**

- Cost – Contact the EI
- Organization logo placed in the Program Booklet
- Link from ILETSBEI Website to organization's home page
- Two tickets for each meal during the conference
- Invitation to networking reception
- Discounted conference registration price for organization staff who want to attend the conference as participants

### **Unattended Exhibitor Booth**

- Cost - \$150
- Information displayed on draped table in Exhibitor area
- Exhibitor logo placed in the Program Booklet

### **Additional Table for Display**

- Cost - \$50

### **Underwriter**

Special recognition for sponsors in print materials, signage; co-sponsorship is accepted.

Sponsors may choose to partially underwrite an event with the exception of Welcome Bag Insert.

### **Welcome Bag Inserts**

- Cost - \$125
- Placement of pamphlet, postcard, business card, promotional item (up to 3 sheets of information) in attendee welcome bags
- Exhibitor logo placed in the Program Booklet
- Fee is in addition to any booth cost
- Items must be received by ILETSBEI no later than 1 week prior to the conference

### **Conference Networking Reception, Tuesday**

- Cost - \$3000
- Host Logo on large signage in Reception area
- Host Logo placed in the Program Booklet
- Host name and Logo on sheet in Welcome Bag for attendees
- Host Logo placed on ILETSBEI website
- Free reception tickets for up to 5 additional attendees from host sponsor

### **Continental Breakfast**

- Cost - \$4500
- Host Logo on large signage in Reception area
- Host Logo placed in the Program Booklet
- Host name and Logo on sheet in Welcome Bag for attendees
- Host Logo placed on ILETSBEI website
- Free reception tickets for up to 5 additional attendees from host sponsor

### **Lunch Session**

- Cost - \$7500
- Host Logo on large signage in Lunch area
- Host Logo placed in the Program Booklet
- Host name and Logo on sheet in Welcome Bag for attendees
- Host Logo placed on ILETSBEI website
- Free lunch for up to 5 additional attendees from host sponsor

### **Coffee Breaks/Refreshments during Conference**

- Cost - \$350/day
- Host Logo on large signage in Break area
- Host Logo placed in the Program Booklet
- Host name and Logo on sheet in Welcome bag for attendees
- Host Logo placed on website

### **Giveaways & Door Prizes**

Some of the fun at the *Women in Criminal Justice Conference* is giveaway items to participants throughout the conference.

### **Giveaways & Prize Donation**

- No cost – Provide door prizes to be given away during breaks, evening reception, luncheon, and general sessions

## EXHIBITOR INFORMATION

### Why be an exhibitor?

1. We are dedicated to your success! We want you to be visible to all attendees!
2. We have a number of choices to fit your budget and will work with you if you have another idea for sponsorship!
3. There are many ways for your company to stand out including signage, name and logo recognition in the program, and links on the ILETSBEI website!

### *Exhibitor Contact Information*

Cindi Bricker, ILETSBEI  
[cj-bricker@wiu.edu](mailto:cj-bricker@wiu.edu)  
309-298-2646

### *Show Dates and Exhibiting Hours*

April 12-13, 2022

#### Set-up

April 12, 2022  
8:00 am – 10:00 AM

\*Set-up may be available the evening of April 11, 2022  
Contact Cindi Bricker the week prior for more details

#### *Exhibits Open*

10:00 am – 5:00 pm Tuesday, April 12, 2022  
8:00 am – 11:30 am Wednesday, April 13, 2022

Remove booth by Noon, April 13, 2022

#### *Hotel Information*

Bloomington-Normal Marriott Hotel and Conference Center  
201 Broadway Street  
Normal, IL 61761  
[Bloomington-Normal Marriott Website](#)  
309-862-9000

#### *Cancellation*

Must be received in writing on or before  
March 31, 2022 to Cindi Bricker

***Be sure to mention you are with the ILETSBEI Women in Criminal Justice Conference!***

## SAMPLE EXHIBITOR/SPONSORSHIP APPLICATION INFORMATION

Credit card or Check payment accepted. To pay by check complete the [Online Application Form and Contract Information](#) and mail/email to:

**ILETSBEI**  
**Attn: Cindi Bricker**  
**1 University Circle**  
**Macomb, IL 61455**  
[Cj-bricker@wiu.edu](mailto:Cj-bricker@wiu.edu)

<b>Sponsorship Level</b>	<b>Cost</b>
<b>Exhibitor Services</b>	
Corporate Attended Booth	\$500
Not For Profit Attended Booth	Contact EI
Unattended Exhibitor Booth	\$150
Additional Table for Display	\$50
<b>Hosting Events</b>	
Conference Reception – Contact Cindi Bricker	\$3,000
Conference Continental Breakfast – Contact Cindi Bricker	\$4,500
Conference Luncheon – Contact Cindi Bricker	\$7,500
Coffee Breaks/Refreshments (per day) – Contact Cindi Bricker	\$350
<b>Other Options</b>	
Welcome Bag Information Inserts (Mail at least 1 week prior to the conference)	\$125
Giveaways & Door Prize Sponsorship	\$200
Giveaways & Door Prize Donation (Please bring door prizes to the registration desk at check-in/setup)	N/A
<b>Total (Please enter total exhibitor/sponsorship cost here for your selections):</b>	

Additional meal tickets may be purchased for \$25 each above and beyond the level of exhibitor/sponsorship package.

**SECOND FLOOR**

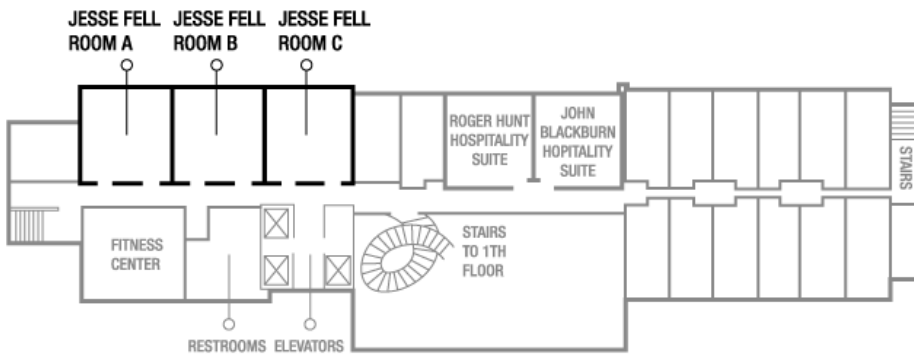

**FIRST FLOOR**

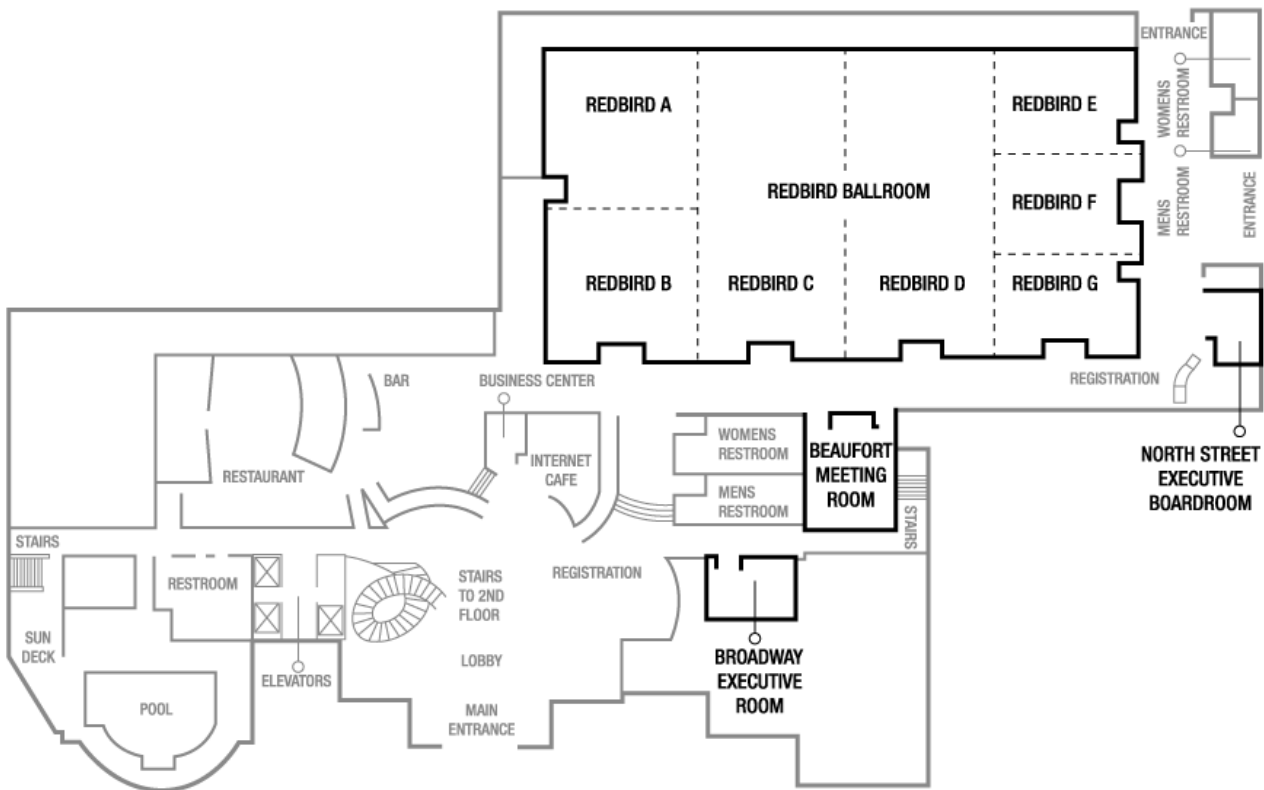





Thank you for your support of the  
ILETSB Executive Institute  
Women in Criminal Justice Conference!

*We couldn't do it without you!*

[Click Here to Register Online as an Exhibitor](#)

Or visit our website at  
[www.iletsbei.org](http://www.iletsbei.org)

Contact Information

Cindi Bricker, Manager of Operations  
cj-bricker@wiu.edu  
309-298-2646